

**NEARSIDE BUS TURNOUT**

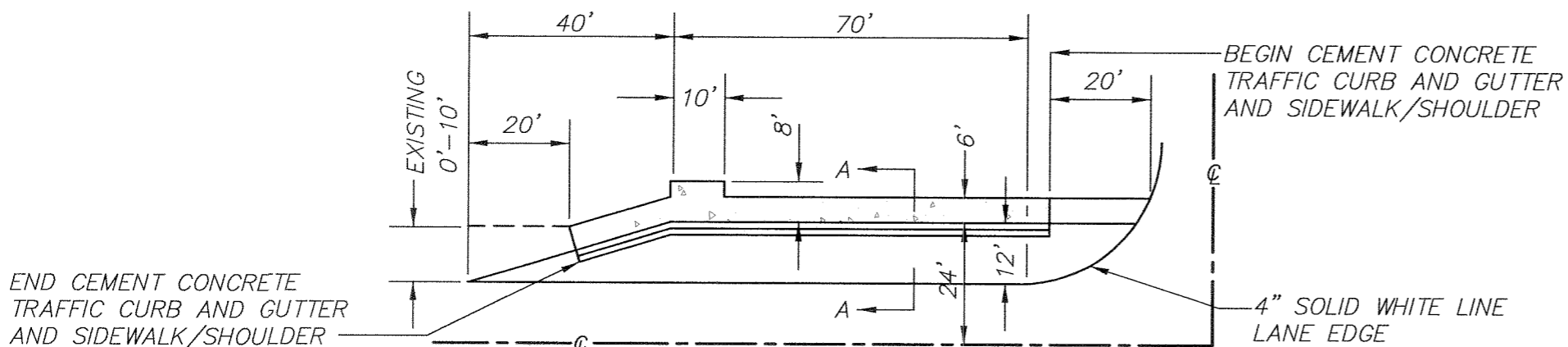

**FARSIDE BUS TURNOUT**

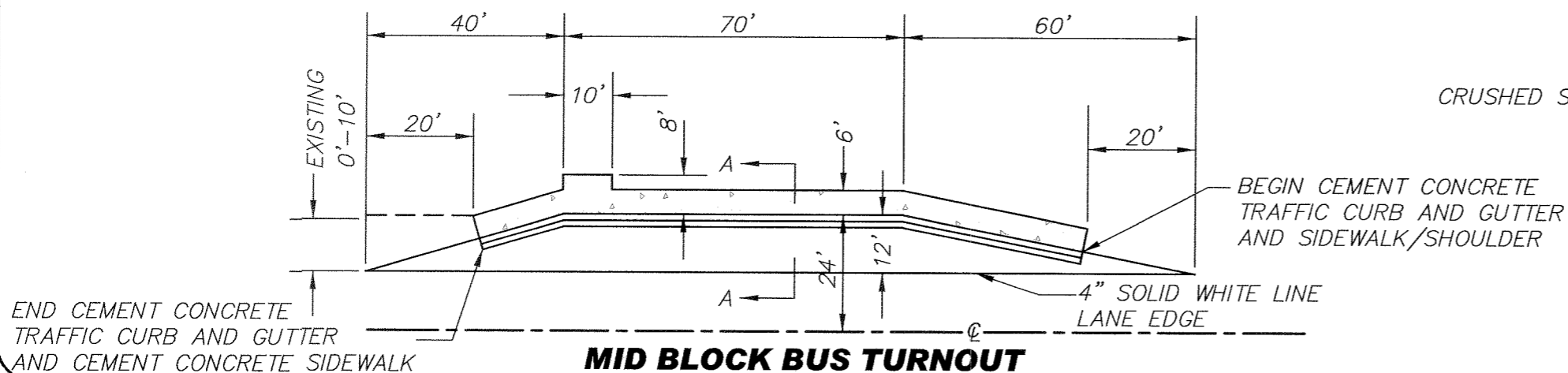

**MID BLOCK BUS TURNOUT**

**NOTES:**

- 1) STORM DRAINAGE FACILITIES MUST BE INSTALLED AS REQUIRED BY EXISTING TOPOGRAPHIC CONDITIONS.
- 2) PIERCE COUNTY TRAFFIC OPERATIONS TO BE CONTACTED BEFORE STRIPING IS DONE.
- 3) ADD 50 FEET FOR EACH ADDITIONAL BUS IN LOADING AREA.
- 4) EXISTING ROAD WITH LANES LESS THAN 12 FEET WIDE MUST BE WIDENED AS NECESSARY TO ACCOMODATE THE BUS TURNOUT.
- 5) INSTALL CURB TRANSITION(S) TO EXISTING SHOULDER(S) SEE STANDARD DRAWING PC.F8.2.
- 6) IF EXISTING ROAD HAS EXISTING CURB AND GUTTER AND SIDEWALK, CONTINUE THESE TO MEET BUS TURNOUT CURB AND GUTTER AND SIDEWALK.

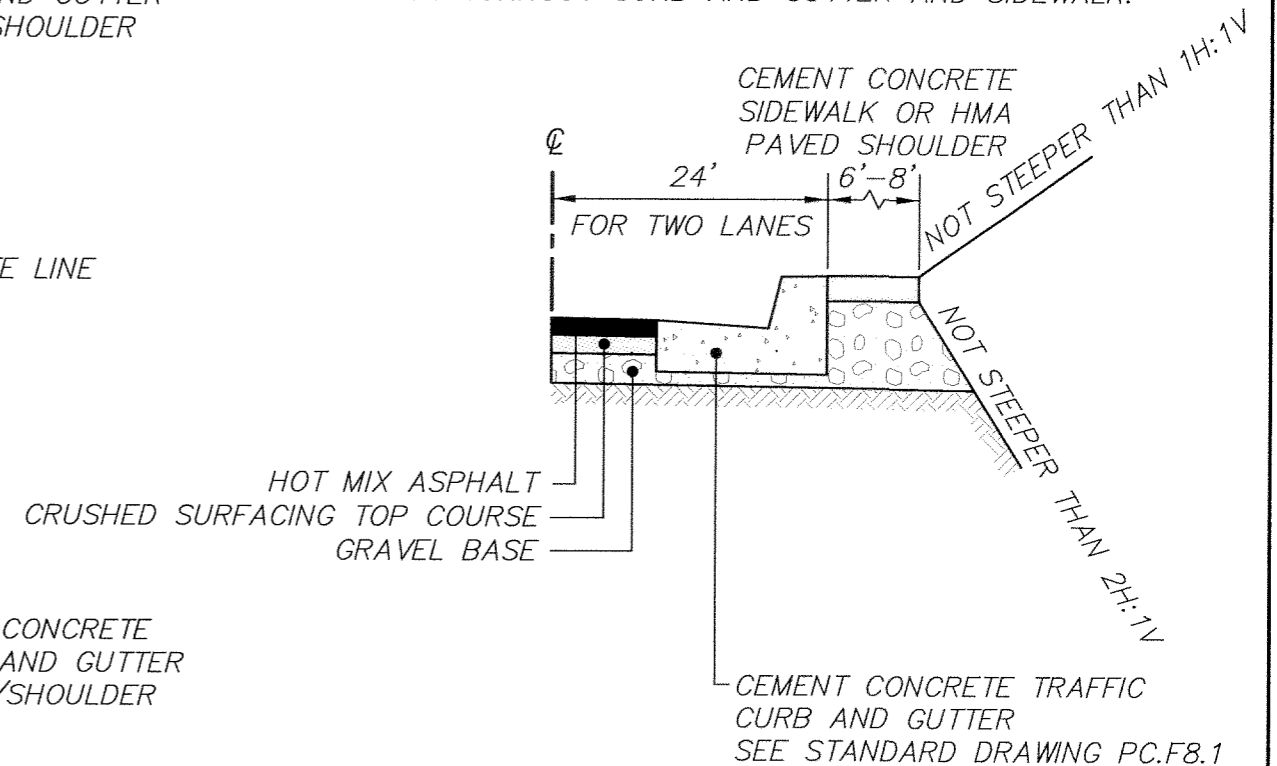

**SECTION A-A**

(NOT TO SCALE)



**Pierce County**

Department of Public Works and Utilities  
Transportation Services  
2702 South 42nd Street, Suite 201  
Tacoma, Washington 98409-7322

DATE	REVISION	APPROVED	DRAWN



**BRIAN D. STACY, P.E.**  
**COUNTY ENGINEER**

Office of County Engineer

EXPIRES: 11/18/06

12-8-05

**BUS TURNOUT**

**PC.A8**