

Planning and Site Design of Sustainable Low Impact Development Projects

**Lorin Reinelt, Ph.D.
Watershed and Lead Entity Coordinator
Pierce County Water Programs**

Project Site Evaluation and Analysis

Evaluate site to determine development opportunities and site environmental constraints

- Identify natural resources, and topographic and soil constraints
- Fit the development to the site
- Establish forest/open space retention areas and impervious surface limits (65/10, 75/5, 50/20)
- Maintain and re-use top soil, woody debris and other vegetation

Conduct a Site Inventory

Identify natural resource protection areas onsite

- Forest retention (tree conservation areas)
- Salmon spawning and rearing, and wildlife habitat
- Streams, wetlands, and groundwater recharge areas
- Steep slopes and other critical areas

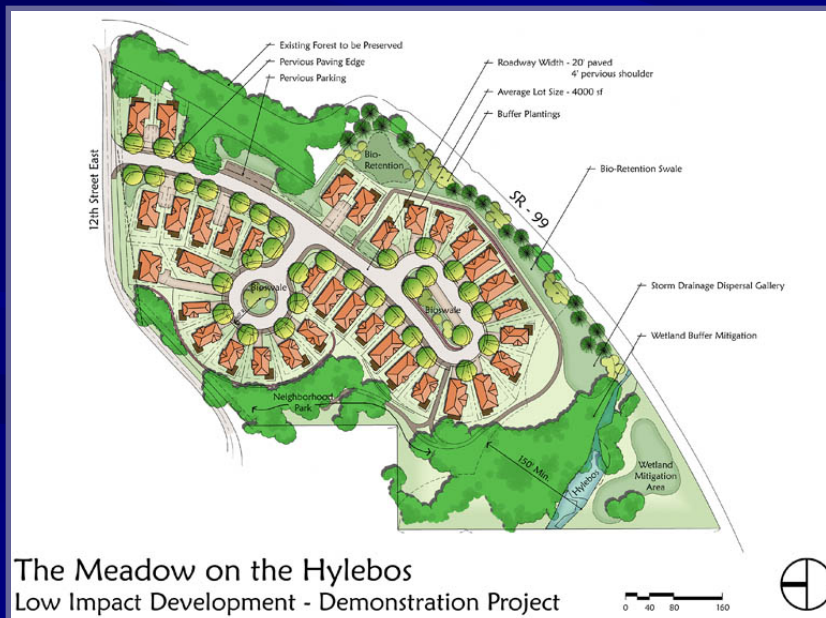

The Meadow on the Hylebos
Low Impact Development - Demonstration Project

Site Design Process

Site Considerations for Development

- Identify forest retention and open space protection areas
- Orient developed areas to minimize site disturbance
- Eliminate or reduce number of stream crossings

Site Design Process (cont'd)

- Minimize impervious surfaces – reduce building footprints, road length and width where feasible
- Layout roads and lots to follow contours, where feasible
- Direct rooftop runoff to infiltration areas
- Integrate small, dispersed bioretention areas to capture, store, and infiltrate stormwater

Retain Native Vegetation; Re-forest

Retain large, connected tracts of native vegetation

- Use cluster design, or retain forest on individual lots
- Maintain natural hydrologic function
- Provide infiltration areas for overland flows
- Commercial LID – retain 25% native vegetation
- Protect vegetation during and post-construction

Reduce Effective Impervious Surfaces

Reduce EIA associated with roads, sidewalks, driveways and parking areas

- Reduce road width and length; sidewalks on one side of street
- Restrict on-street parking
- Explore alternative paving materials
- Disconnect sidewalks from the traveled roadway
- Design clusters of homes to utilize shared driveways

Reduced Effective Impervious Surfaces



Issaquah Highlands Development

King County 4:1 Project (open space - urban ratio)

- 1400 acres open space
- 500 acres urban (75/20)
- Avoid development in:
 - ✓ Canyon Cr (coho stream)
 - ✓ N. Fork Issaquah wetland #7 (large class 1 wetland)
 - ✓ Steep East

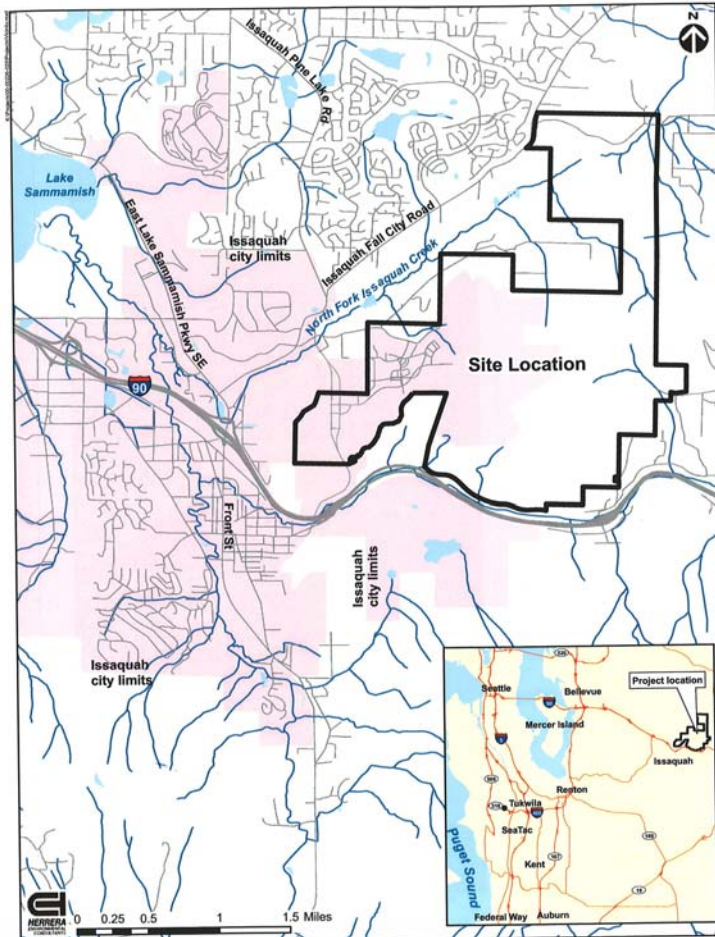
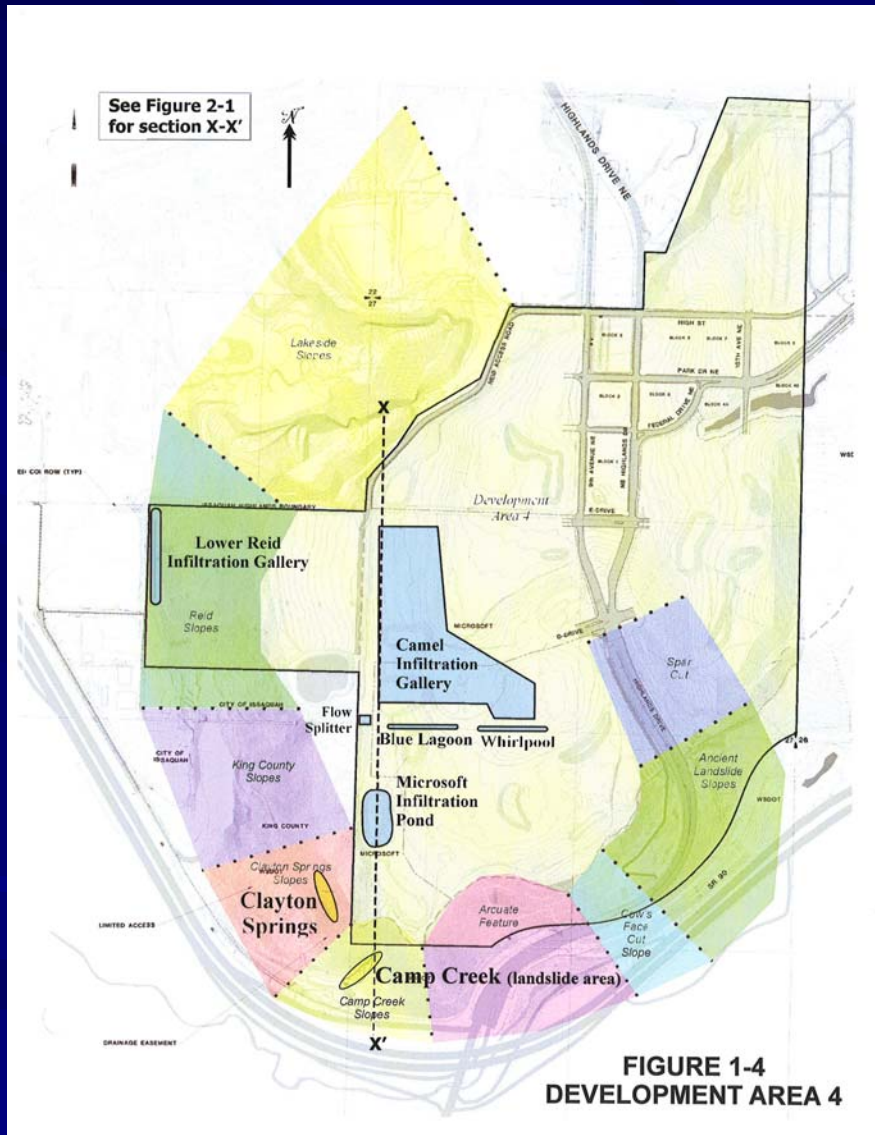

Figure 1. Vicinity and location map of the Issaquah Highlands development, Issaquah, Washington.

Iss. Highlands Stormwater and Infiltration



Stormwater Management and Infiltration:

- Maintain baseflows at pre-development levels
- Prevent increases in flow rates and volumes
- No net loss of recharge to groundwater

Issaquah Highlands Sub-basins



LEGEND

- BUILT-OUT LAND AREA
- PRE-DEVELOPMENT SUBBASINS

DeGross
Photos
Mo

SOURCE: DEGROSS AERIAL MAPPING, INC. PHOTO TAKEN 12-02-06

HERRERA
ENVIRONMENTAL
CONSULTANTS

2200 Sixth Avenue
Suite 1100
Seattle, Washington
98121-1620
206-441-9080
206-441-9108 FAX
<http://www.herrerainc.com>

DESIGN					
DR	T. PRESCOTT				
CHK					
APVD		NO.	DATE	REVISION	BY

REUSE OF DOCUMENTS

THIS DOCUMENT, AND THE IDEAS AND DESIGNS INCORPORATED HEREIN, AS AN INSTRUMENT OF PROFESSIONAL SERVICE, IS THE PROPERTY OF HERRERA ENVIRONMENTAL, AND IS NOT TO BE USED, IN WHOLE OR IN PART, FOR ANY OTHER PROJECT WITHOUT THE WRITTEN AUTHORIZATION OF HERRERA ENVIRONMENTAL.

DO NOT USE THESE OR OTHER DOCUMENTS FOR ANY OTHER PROJECT WITHOUT THE WRITTEN AUTHORIZATION OF HERRERA ENVIRONMENTAL.

FIGURE 2
ISSAQUAH HIGHLANDS BUILT-OUT LAND
AREAS AS OF DECEMBER 2006

SCALE	
SHEET	
DATE	DEC 2006
DWG	
NO.	
REV.	
DATE	

Path: C:\work\06-0026-027\CD\060207\IssaquahHighlands.mxd
 Plot Date: 7/1/2007 1:31 PM
 Call User: Todd Prescott

Issaquah Highlands – Other Features

- Houses set closer to street; garages on alleys
- Shared driveways
- Reduced road width; on-street parking on one side only
- Dispersion/infiltration systems for roof runoff
- Infiltration ponds/facilities for developed area runoff
- All topsoil reused onsite; onsite tree debris ground for use as hog fuel during construction

Talus Development - Issaquah

KC/Issaquah 3:1 Project (open space - urban ratio)

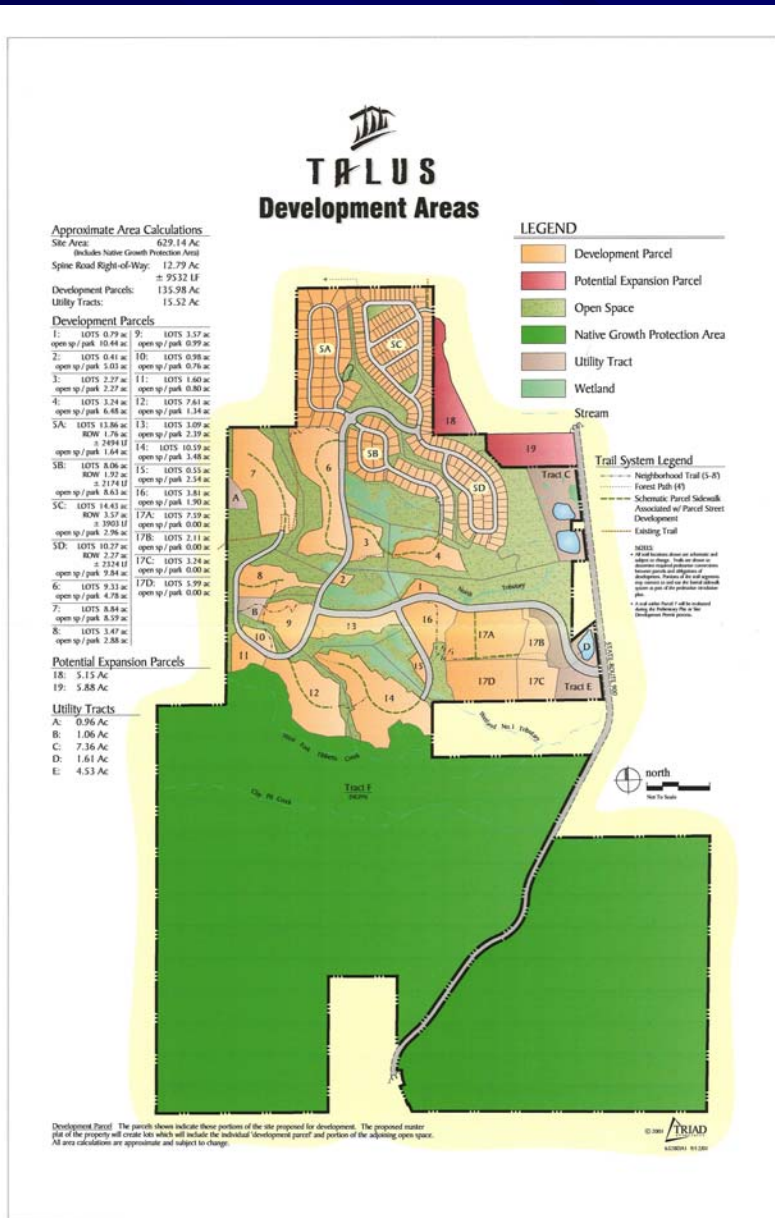

- 630 acres total
- 465 acres open space
- 165 acres urban (75/20)
- Avoid development:
 - ✓ South of West Fork Tibbetts Creek
 - ✓ Large onsite wetlands and buffers
 - ✓ Sand filtration to remove

Low Impact Development BMPs

Focus on infiltrating, dispersing, evaporating, in some cases re-using, and as a last resort, detaining and discharging stormwater

- Infiltration and soil amendment
- Bio-retention and rain gardens
- Dispersion of roof runoff (or green roofs)
- Dispersion of road runoff (or permeable pavement)
- Pervious pavement on driveways, parking stalls and sidewalks
- When these LID BMPs are not feasible, utilize more conventional stormwater management techniques

Benefits of LID and Sustainable Projects



Protect aquatic resources:

- wetlands quality and hydro-period changes
- streams and salmon habitat
- Protect groundwater recharge

Benefits of LID and Sustainable Projects



Protect Water Quality:

- Reduce lake eutrophication
- Minimize instream erosion and incision
- Reduce sediments in wetlands

Benefits of LID and Sustainable Projects



Reduce generation of new runoff and downstream flooding:

- Residential flooding
- Roadway flooding



Other Key Implementation Issues

Construction Phase and Long-term Maintenance:

- Soil compaction and top soil removal
- Erosion and sedimentation
- Long-term maintenance to ensure performance